

SW-32-12-15-W

SE-32-12-15-W

NO. 28918

PLAN NO. 1408

PLAN NO. 28918

PLAN NO. 28918

NW-29-12-15-W

NE-29-12-15-W

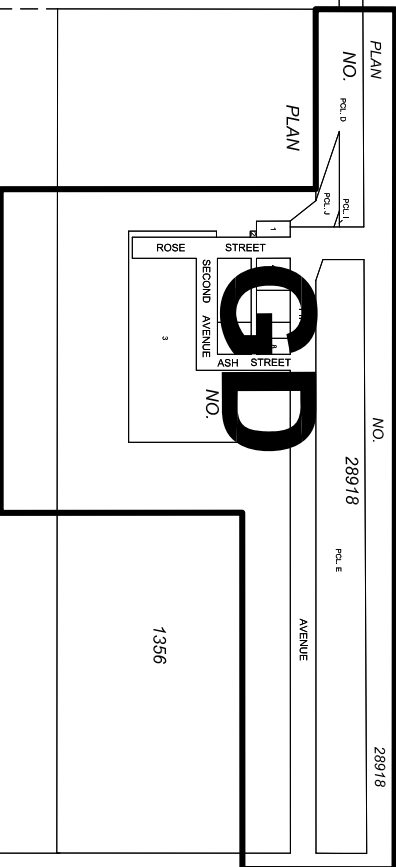

SCHEDULE "A"
 Of By-law No. 6-2010
 Replacing Part Of Zoning
 Map One, Of By-law No. 1896
 as follow:

**Rural Municipality
 of North Cypress**

OBERON

Appendix "A"

**Zoning Map Four
 Of By-law No. 1896**

LEGEND:

"GD" GENERAL DEVELOPMENT
 DISTRICT

— LIMITS OF THE ZONE

MAP 4



Local Government
 Community And Regional Planning

DATE July, 2010 DRAWING NO. ZR Map 4
 REVISED DRAWING NO.